

SOFISTIK AG - www.sofistik.de

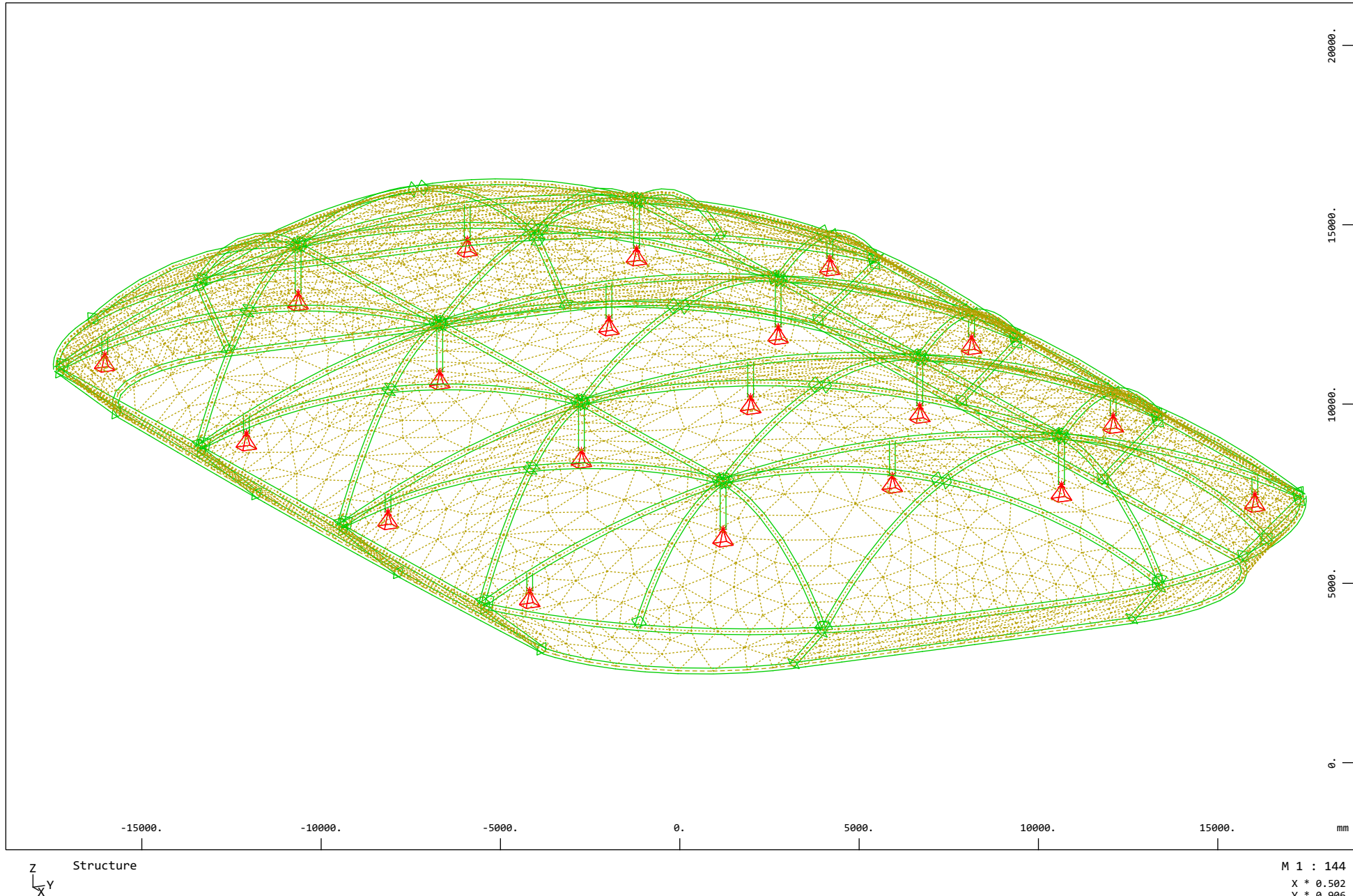

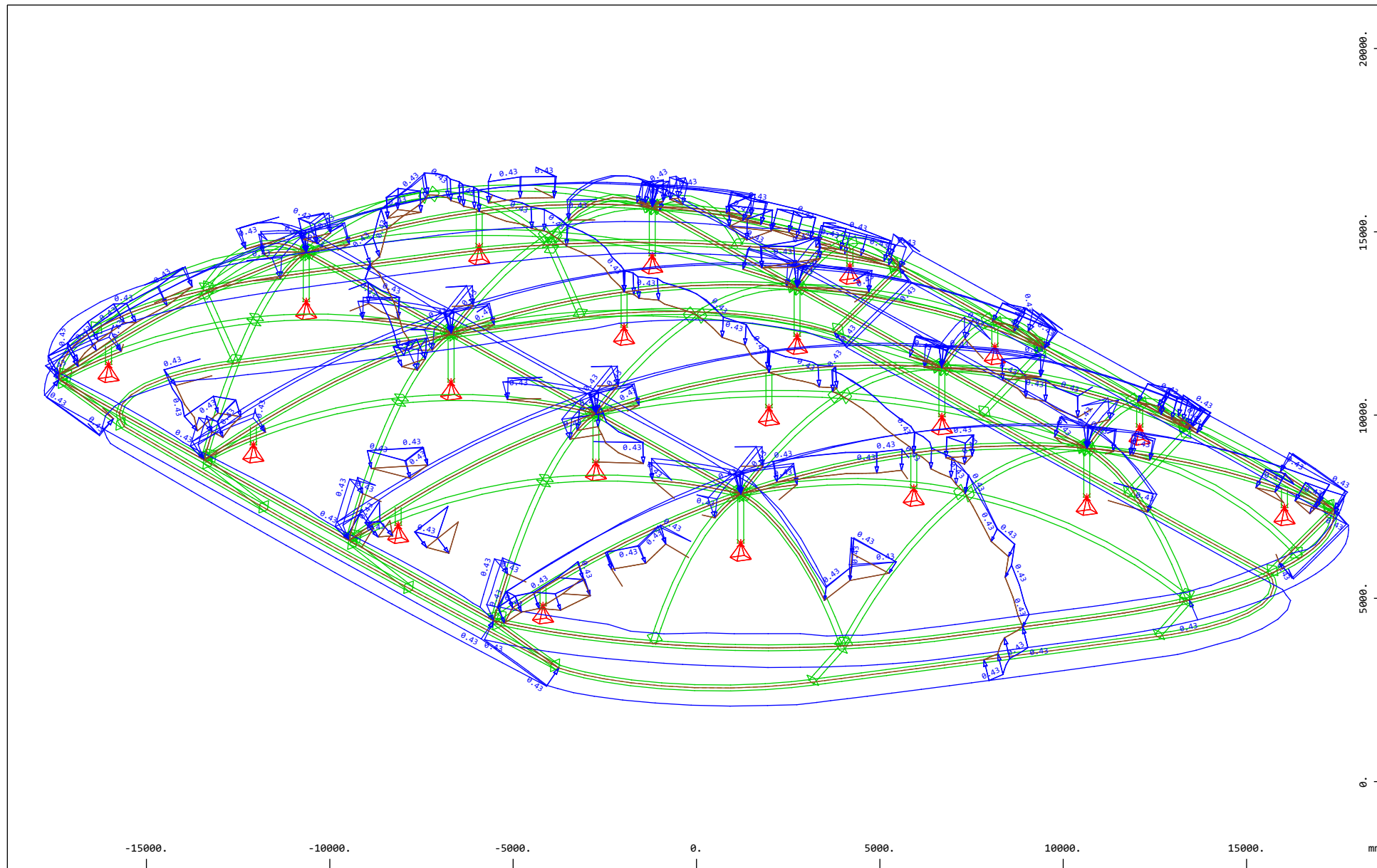





Z  
Y  
X

All loads, Loadcase 21 WIATR W1+, (1 cm 3D = unit) Area element load (force) vector (Unit=1.02 kN/m2)

(Max=0.43)

M 1 : 144

X \* 0.502  
 Y \* 0.906  
 Z \* 0.962



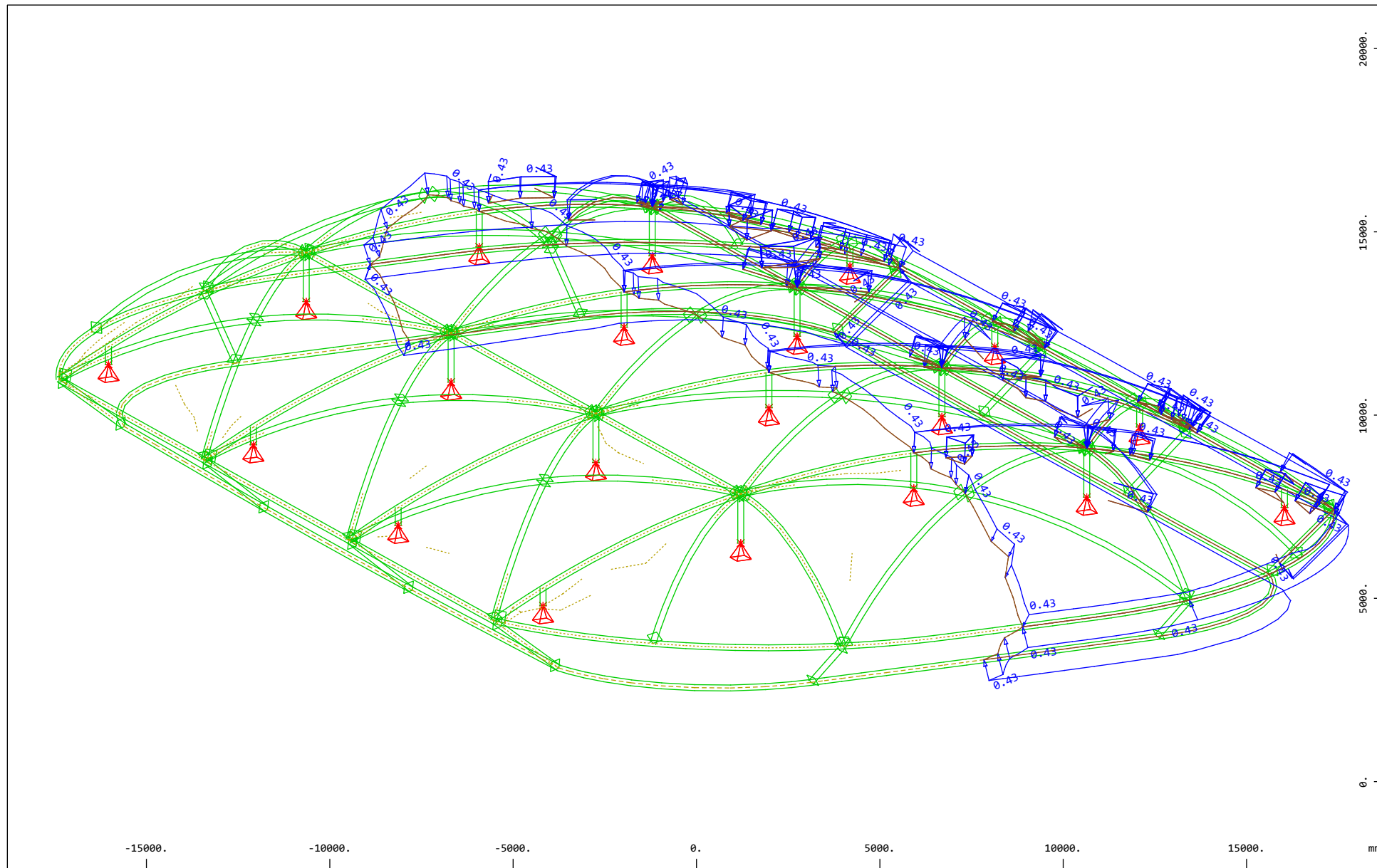

Z  
Y  
X

All loads, Loadcase 22 WIATR W2+ , (1 cm 3D = unit) Area element load (force) vector (Unit=1.02 kN/m2)

(Max=0.43)

M 1 : 144  
 X \* 0.502  
 Y \* 0.906  
 Z \* 0.962

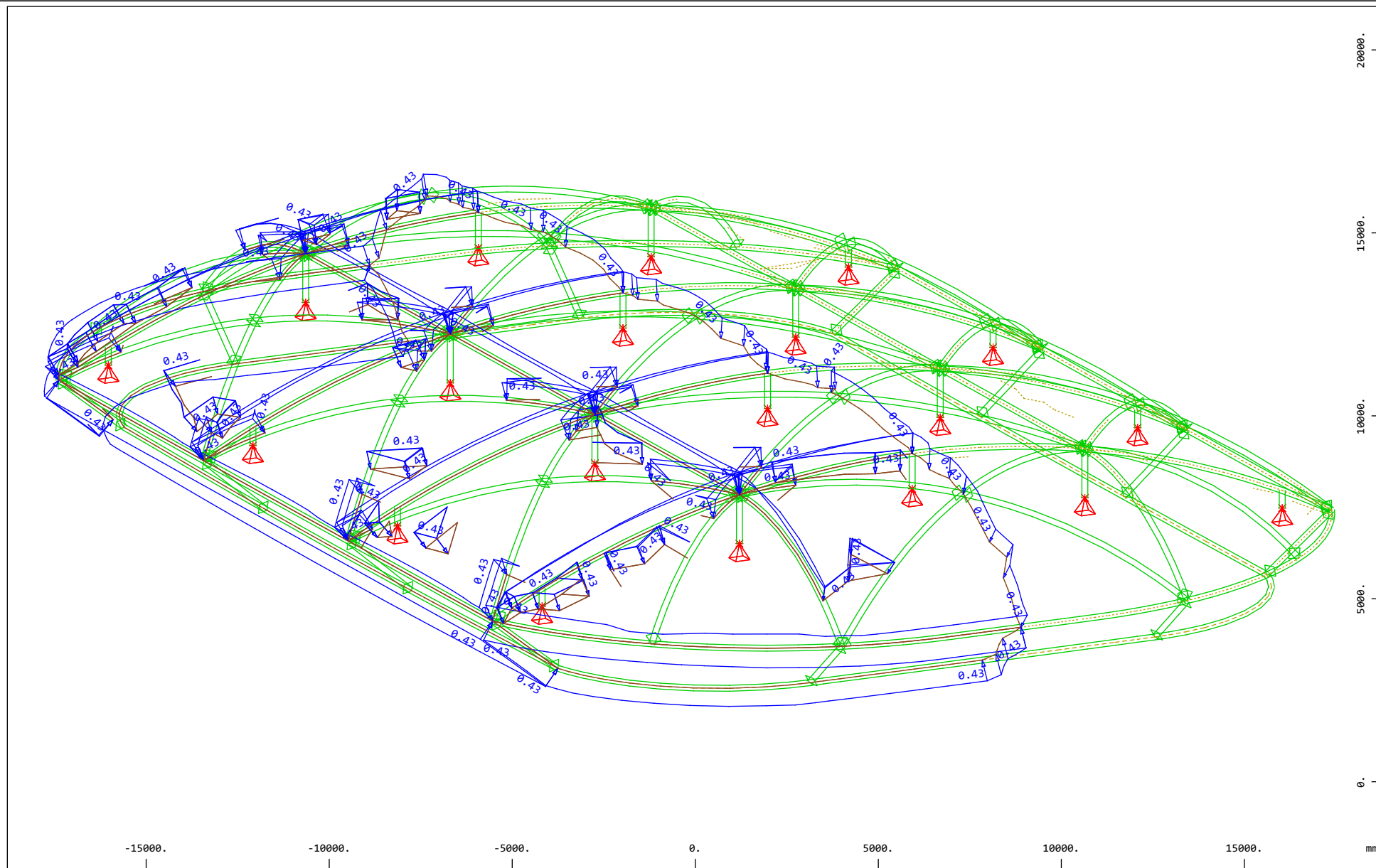

Z  
 X Y

All loads, Loadcase 23 WIATR W3+, (1 cm 3D = unit) Area element load (force) vector (Unit=1.02 kN/m2)

(Max=0.43)

M 1 : 144

X \* 0.502  
 Y \* 0.906  
 Z \* 0.962

SOFISTIK AG - www.sofistik.de

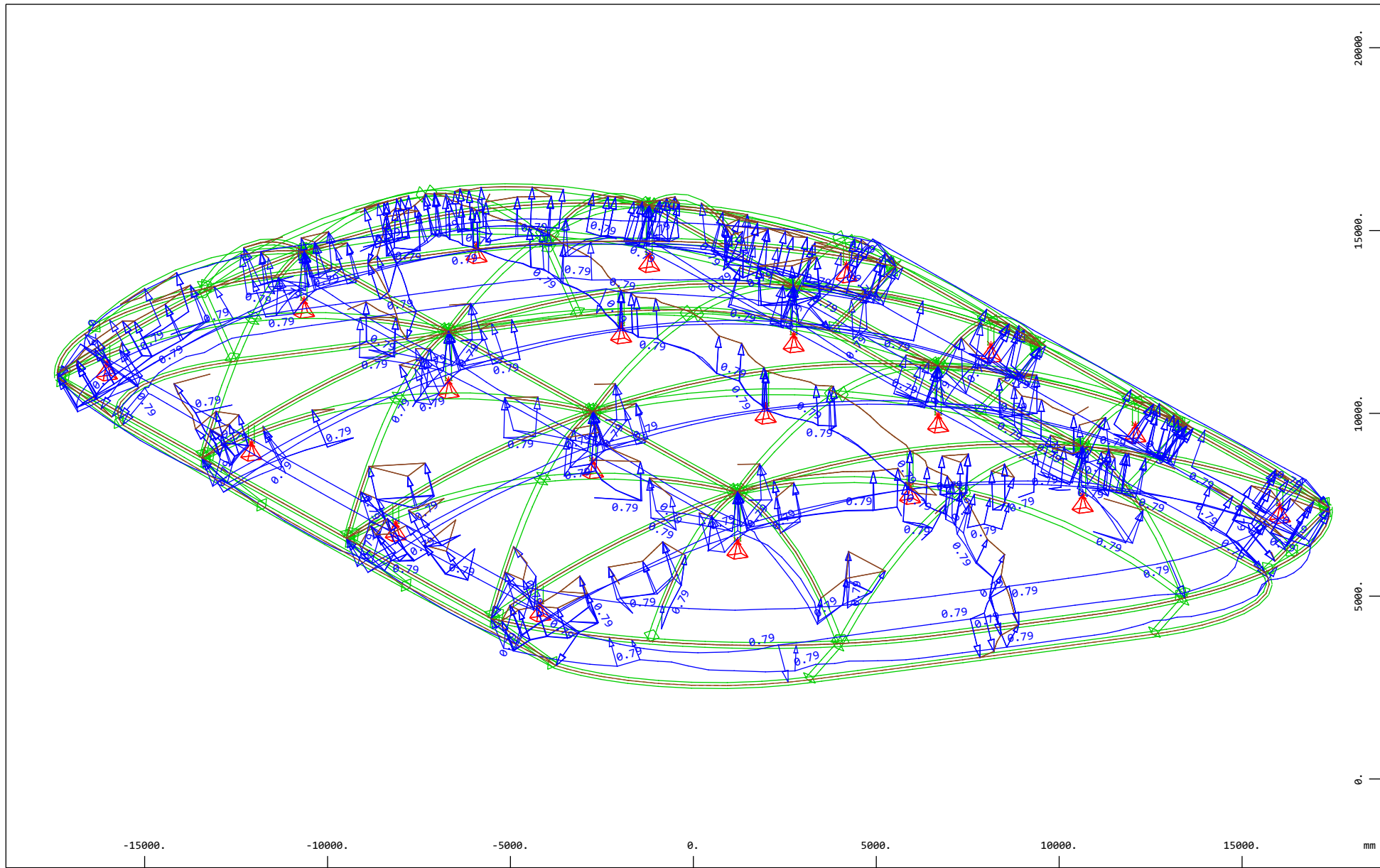

Z  
Y  
X

All loads, Loadcase 24 WIATR W4-, (1 cm 3D = unit) Area element load (force) vector (Unit=1.02 kN/m<sup>2</sup>)

(Max=0.79)

M 1 : 144  
X \* 0.502  
Y \* 0.906  
Z \* 0.962

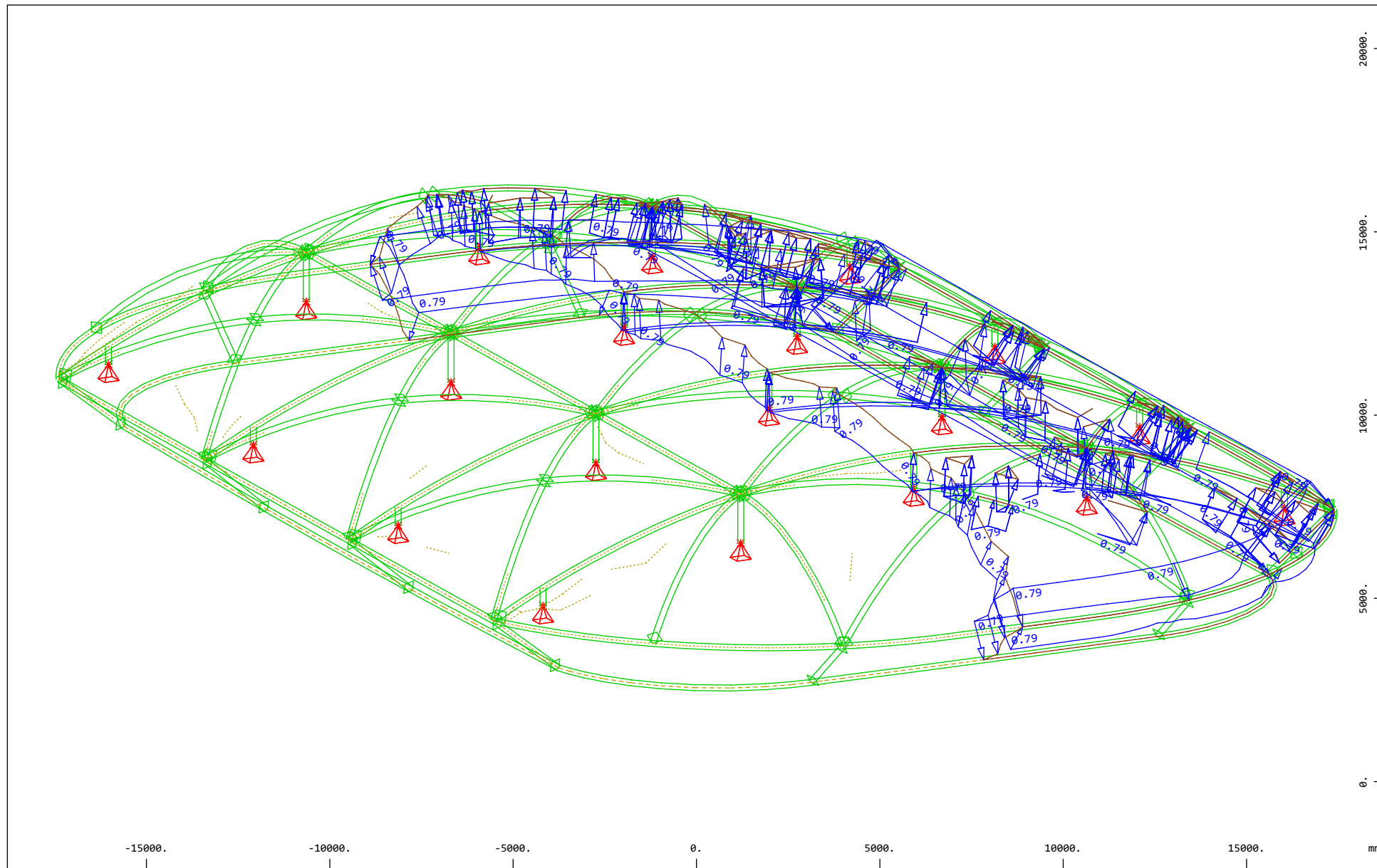

Z  
Y  
X

All loads, Loadcase 25 WIATR W5- , (1 cm 3D = unit) Area element load (force) vector (Unit=1.02 kN/m2)

(Max=0.79)

M 1 : 144  
 X \* 0.502  
 Y \* 0.906  
 Z \* 0.962



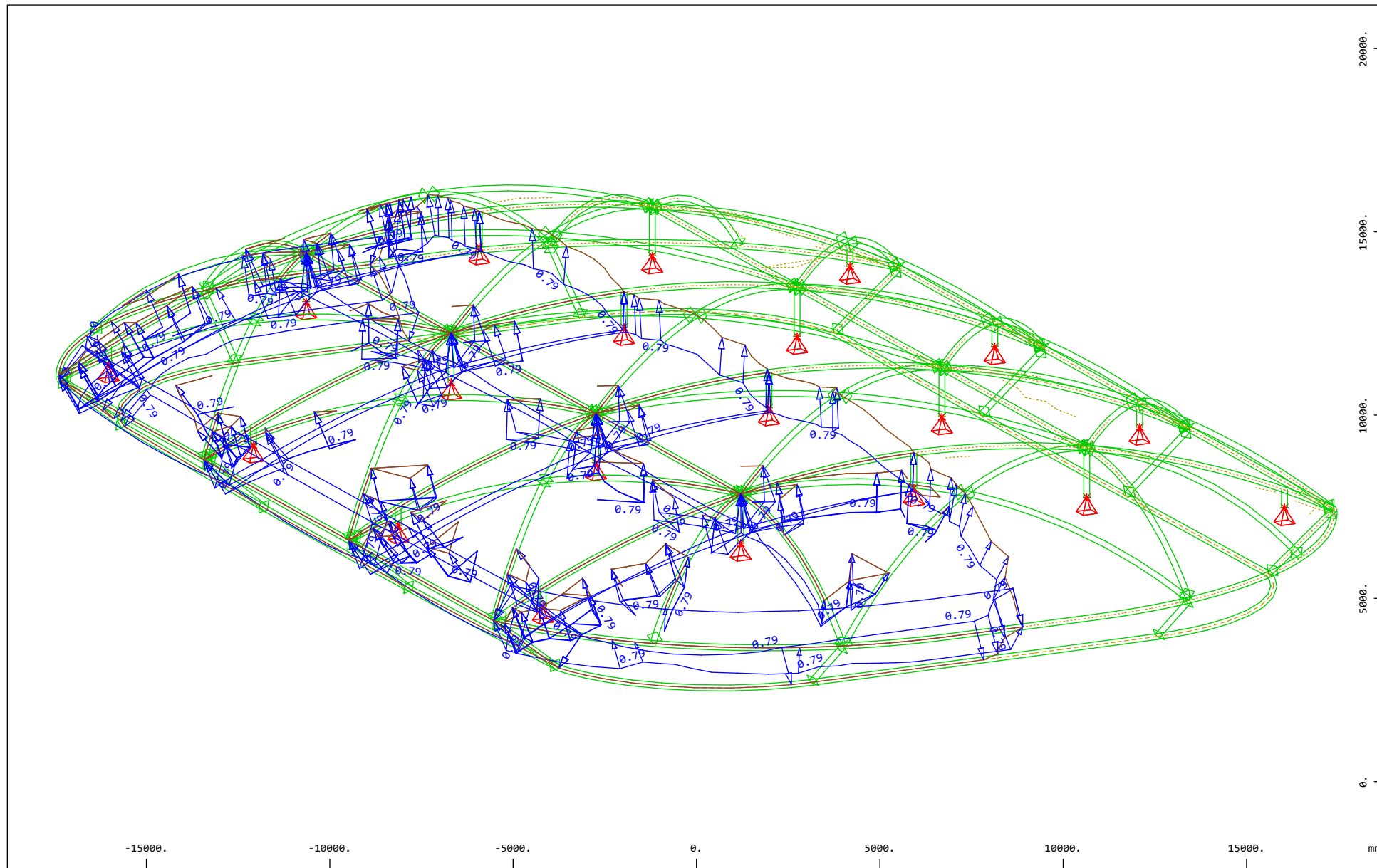

Z  
Y  
X

All loads, Loadcase 26 WIATR W6- , (1 cm 3D = unit) Area element load (force) vector (Unit=1.02 kN/m2)

(Max=0.79)

M 1 : 144

X \* 0.502  
Y \* 0.906  
Z \* 0.962

SOFiSTiK AG - www.sofistik.de

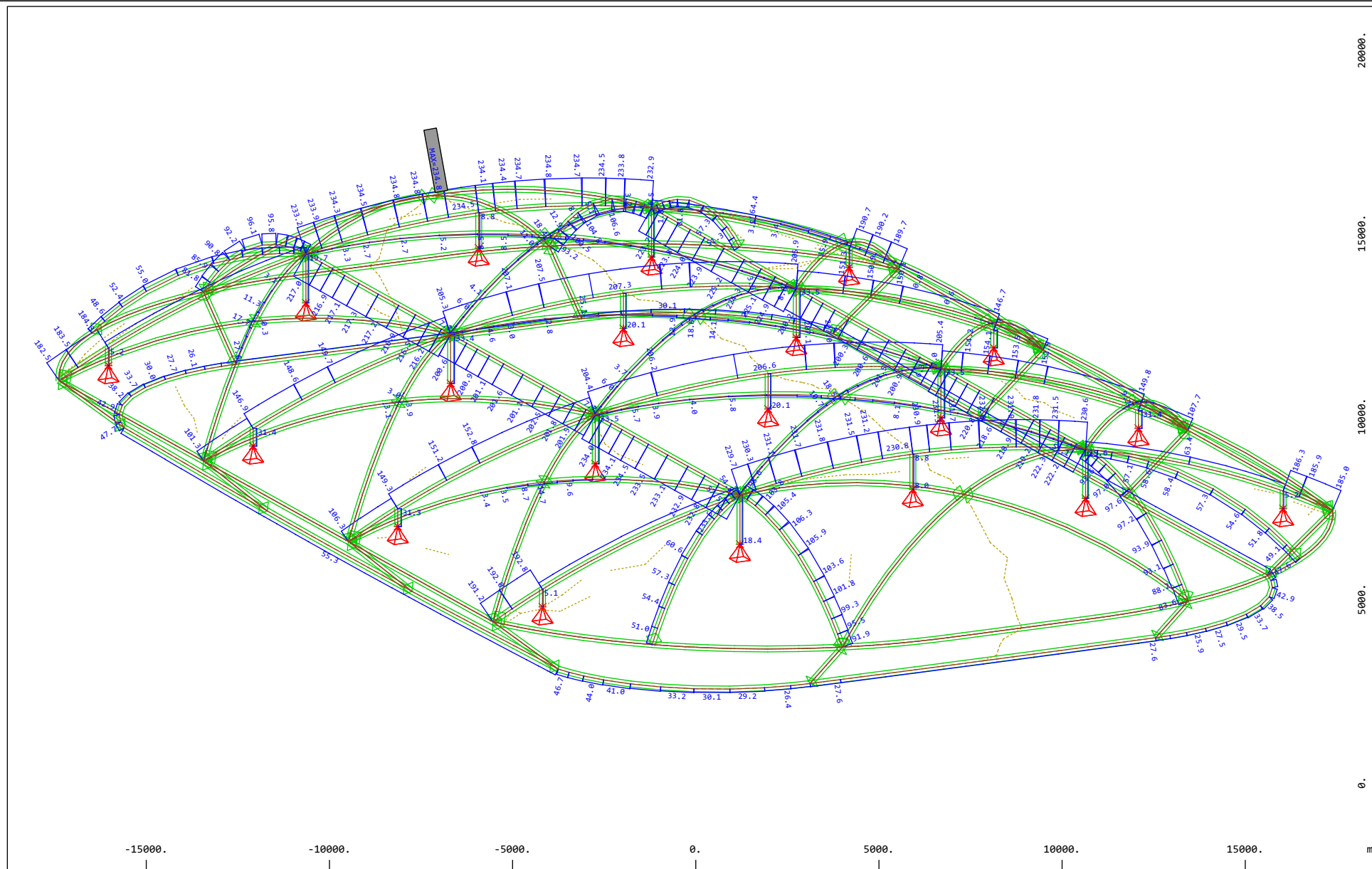

Z  
Y  
X

Beam Elements , Normal force Nx, Loadcase 5100 MAX-N BEAM N , 1 cm 3D = 448.44 kN (Max=234.8)

M 1 : 144  
 X \* 0.502  
 Y \* 0.906  
 Z \* 0.962

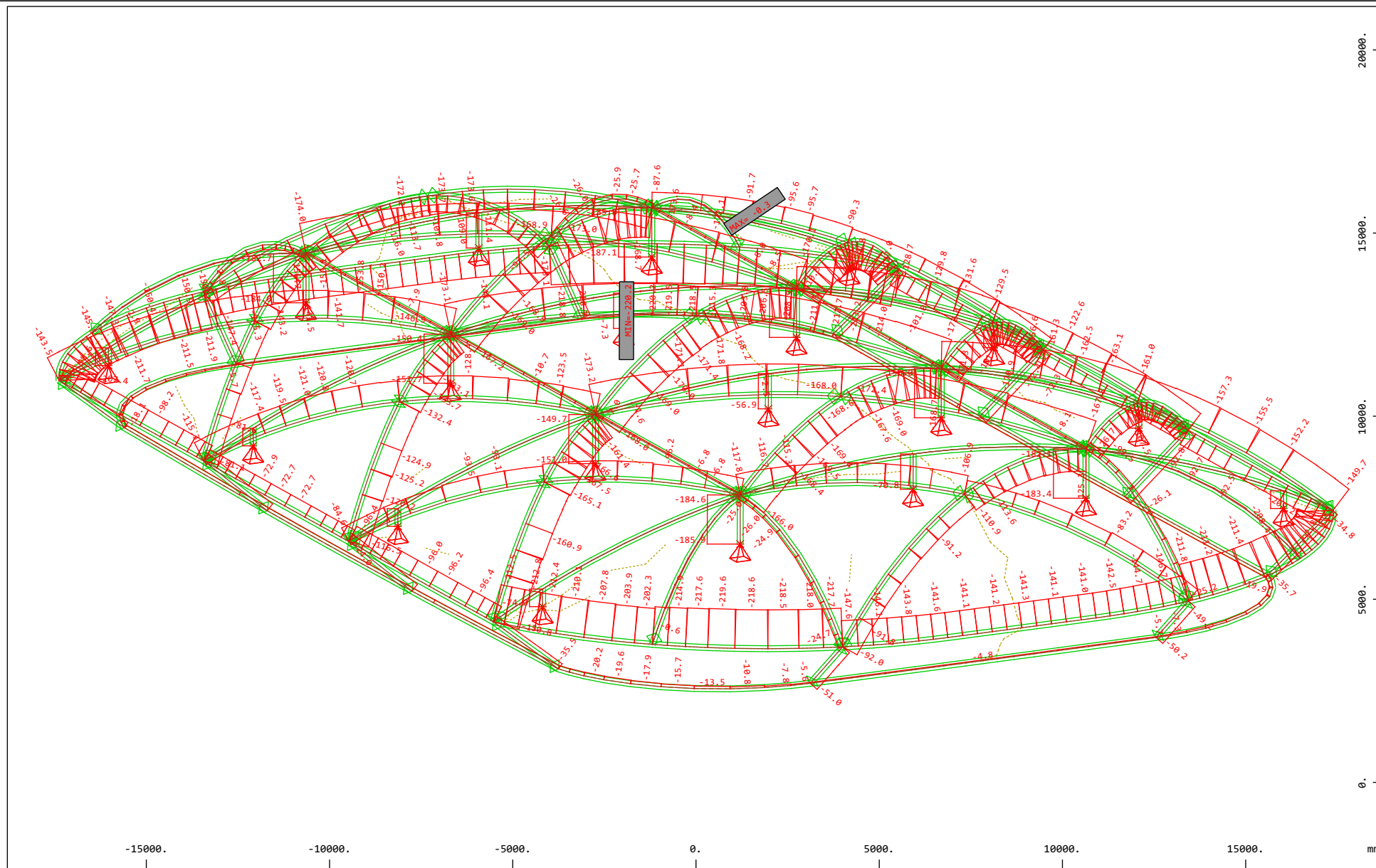

Z  
 X Y

Beam Elements , Normal force Nx, Loadcase 5101 MIN-N BEAM N , 1 cm 3D = 296.88 kN (Min=-220.2) (Max=0)

M 1 : 144  
 X \* 0.502  
 Y \* 0.906  
 Z \* 0.962

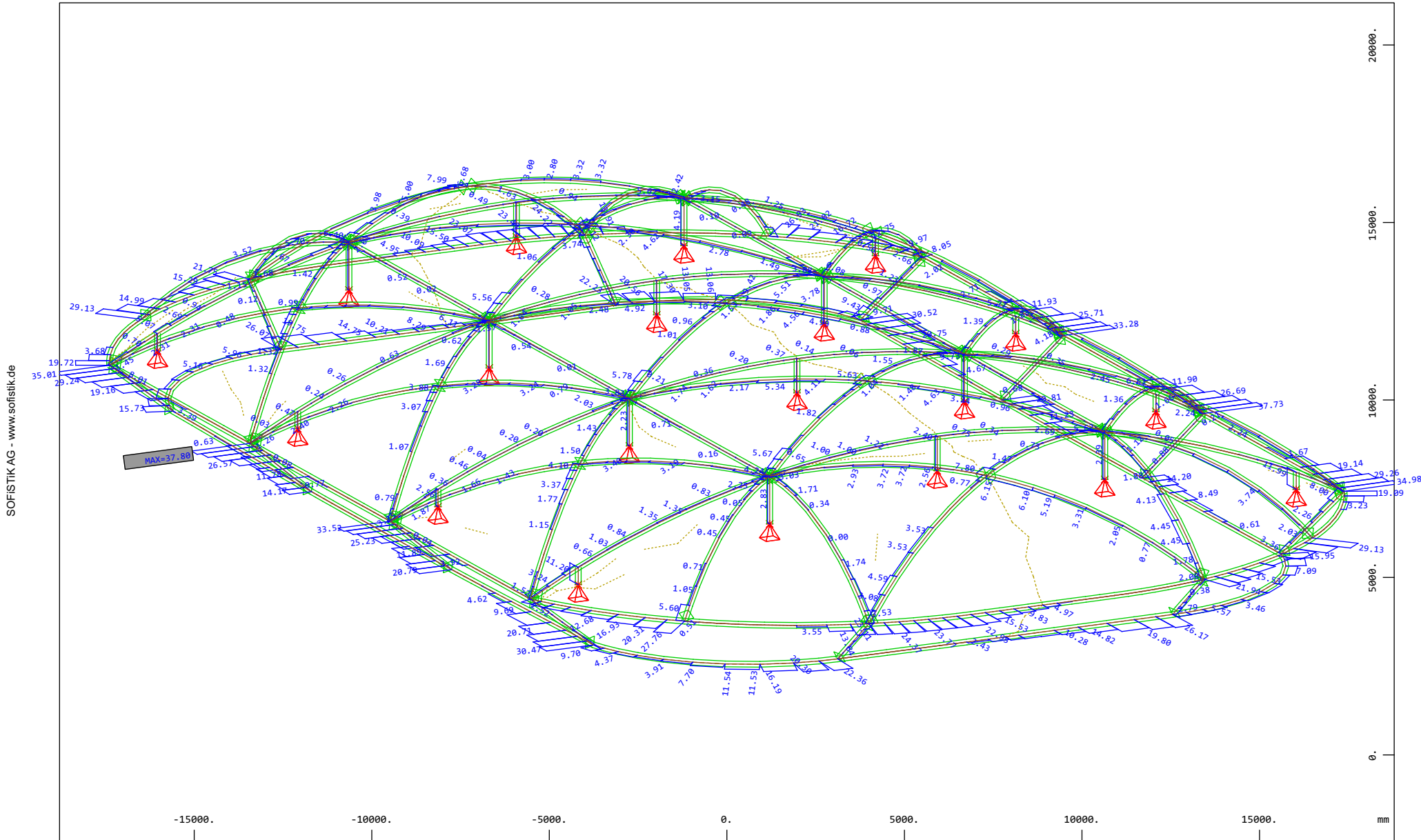

SOFISTIK AG - www.sofistik.de

Z  
X Y

Beam Elements , Shear force Vy, Loadcase 5200 MAX-VY BEAM VY , 1 cm 3D = 29.688 kN (Max=37.80)

M 1 : 144  
X \* 0.502  
Y \* 0.906  
Z \* 0.962



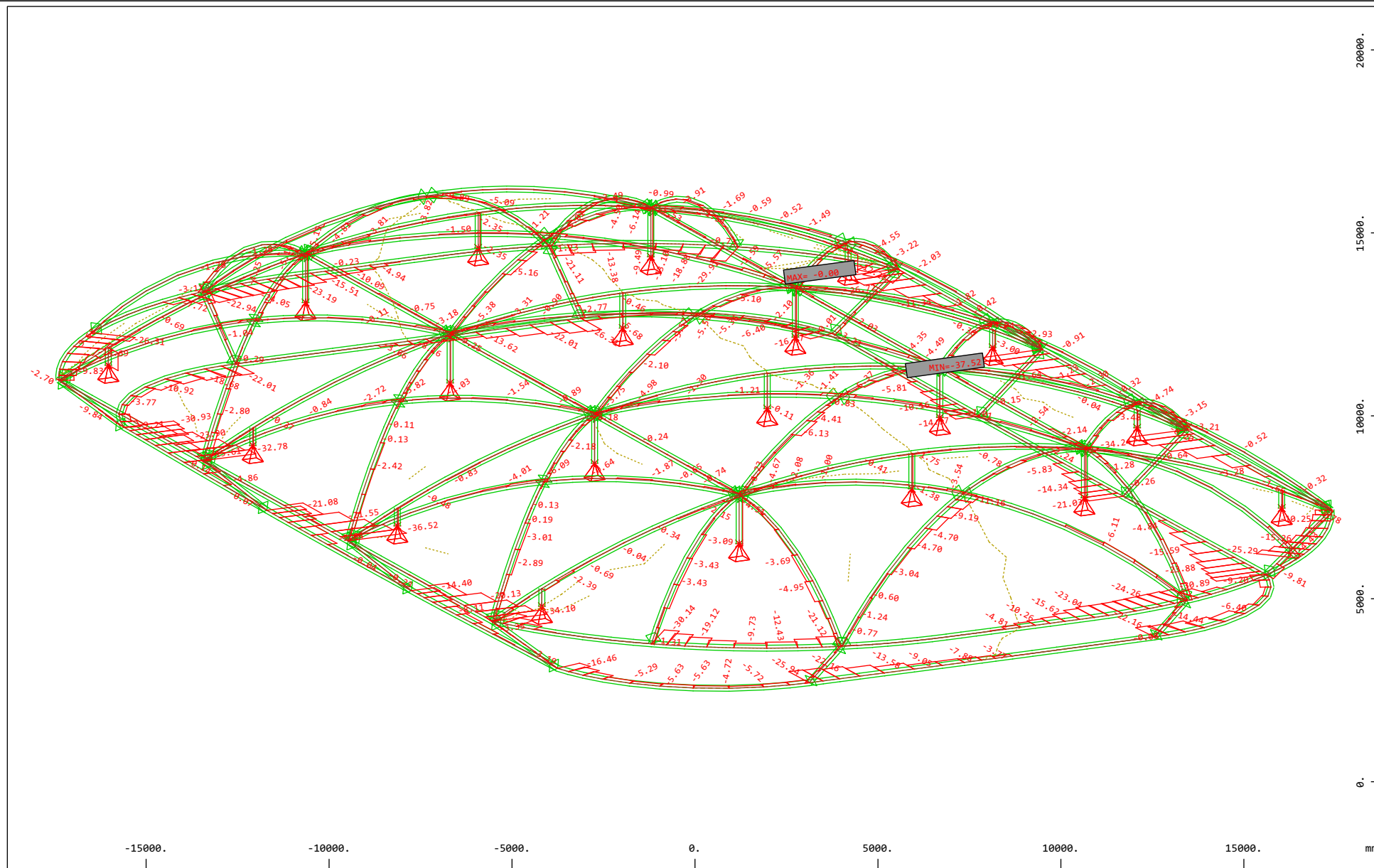

Z  
X Y

Beam Elements , Shear force Vy, Loadcase 5201 MIN-VY BEAM VY , 1 cm 3D = 29.688 kN (Min=-37.52) (Max=0)

M 1 : 144  
 X \* 0.502  
 Y \* 0.906  
 Z \* 0.962

SOFISTIK AG - www.sofistik.de

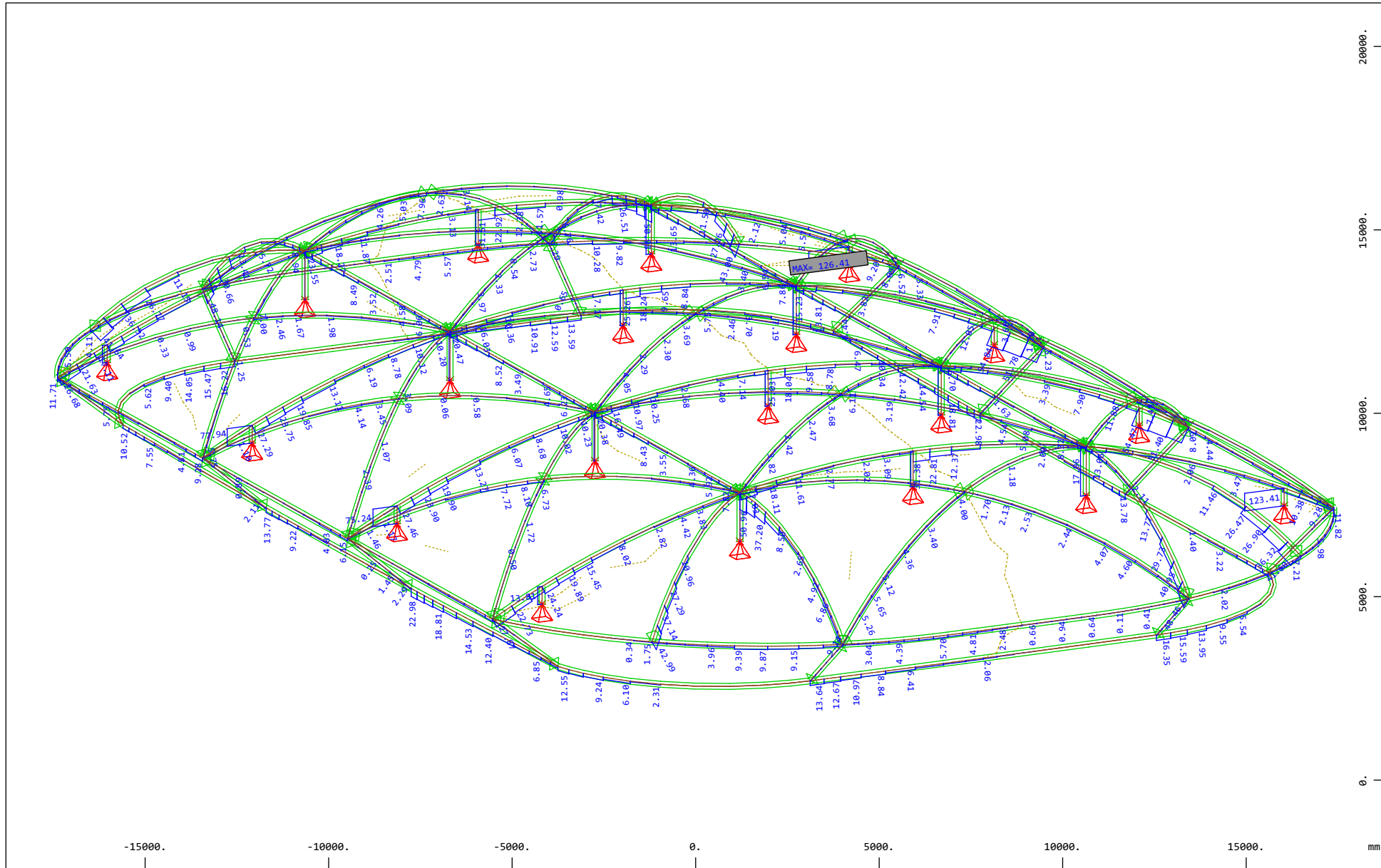

Z  
X Y

Beam Elements , Shear force Vz, Loadcase 5300 MAX-VZ BEAM VZ , 1 cm 3D = 148.44 kN (Max=126.41)

M 1 : 144  
X \* 0.502  
Y \* 0.906  
Z \* 0.962

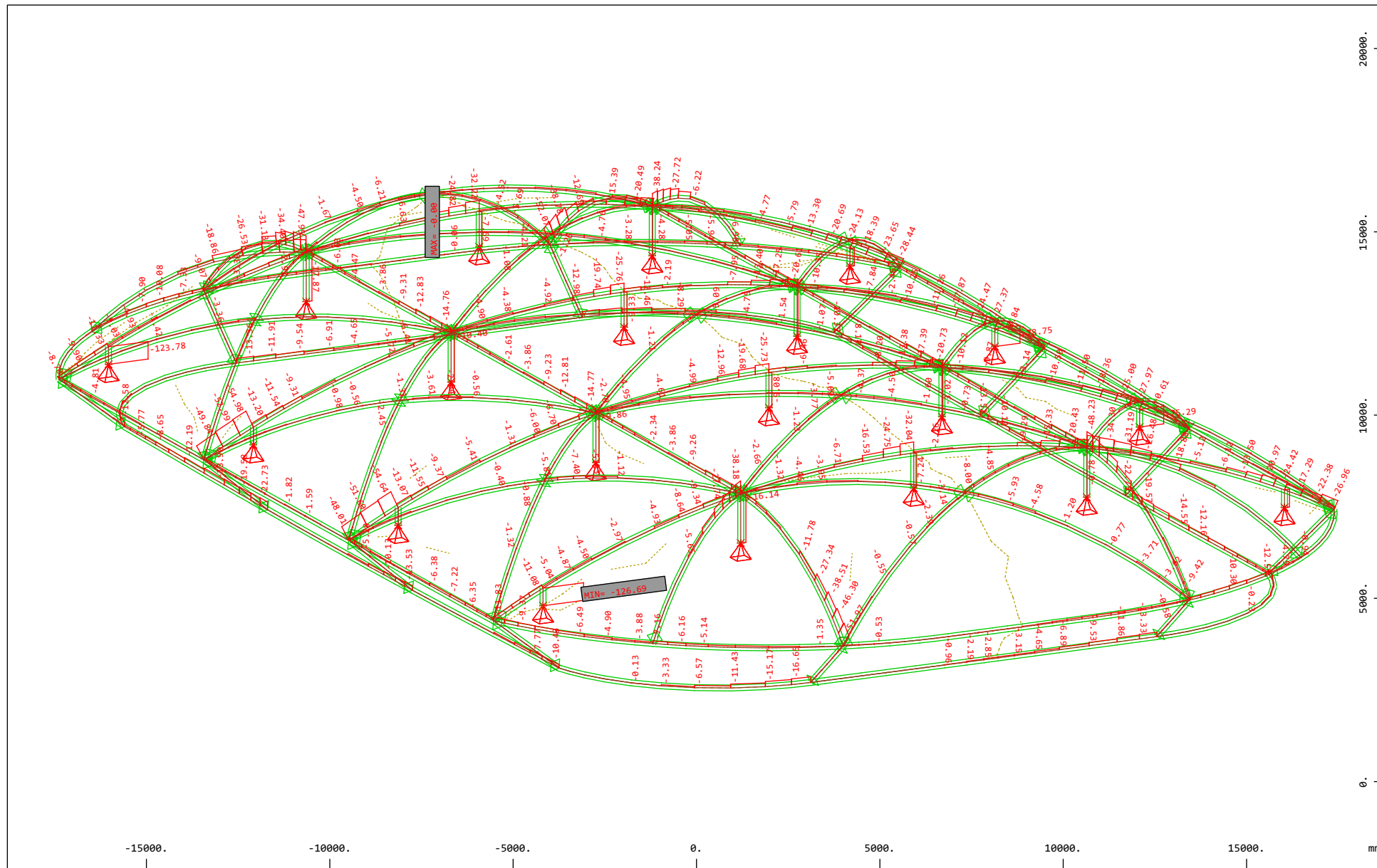

Z  
 X Y

Beam Elements, Shear force Vz, Loadcase 5301 MIN-VZ BEAM VZ, 1 cm 3D = 148.44 kN (Min=-126.69) (Max=0)

M 1 : 144

X \* 0.502  
 Y \* 0.906  
 Z \* 0.962

SOFiSTiK AG - www.sofistik.de

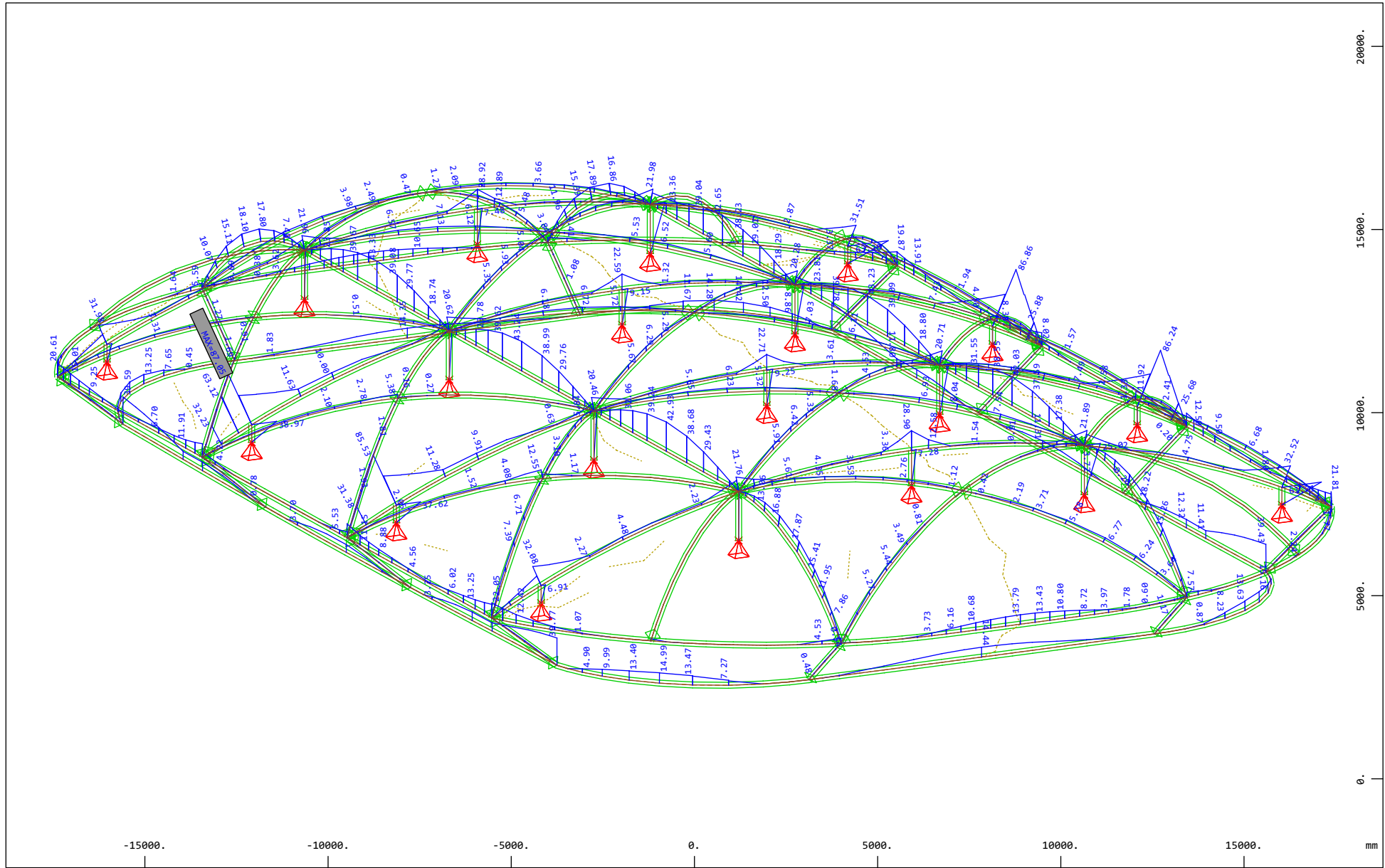

Z  
X Y

Beam Elements , Bending moment My, Loadcase 5400 MAX-MY BEAM MY , 1 cm 3D = 74.219 kNm (Max=87.05)

M 1 : 144  
X \* 0.502  
Y \* 0.906  
Z \* 0.962



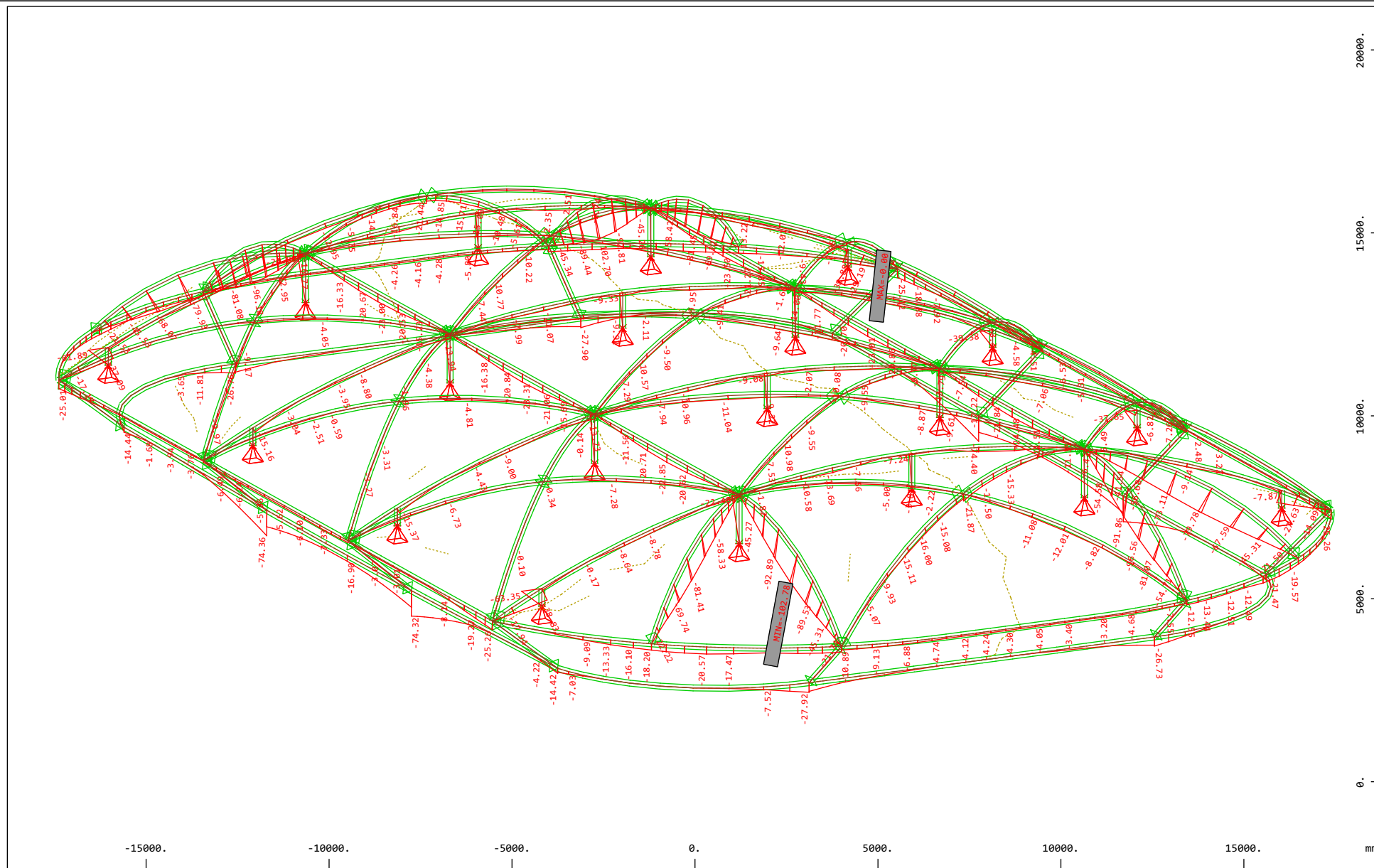

Z  
Y  
X

Beam Elements , Bending moment My, Loadcase 5401 MIN-MY BEAM MY , 1 cm 3D = 148.44 kNm (Min=-102.78) (Max=0)

M 1 : 144  
 X \* 0.502  
 Y \* 0.906  
 Z \* 0.962

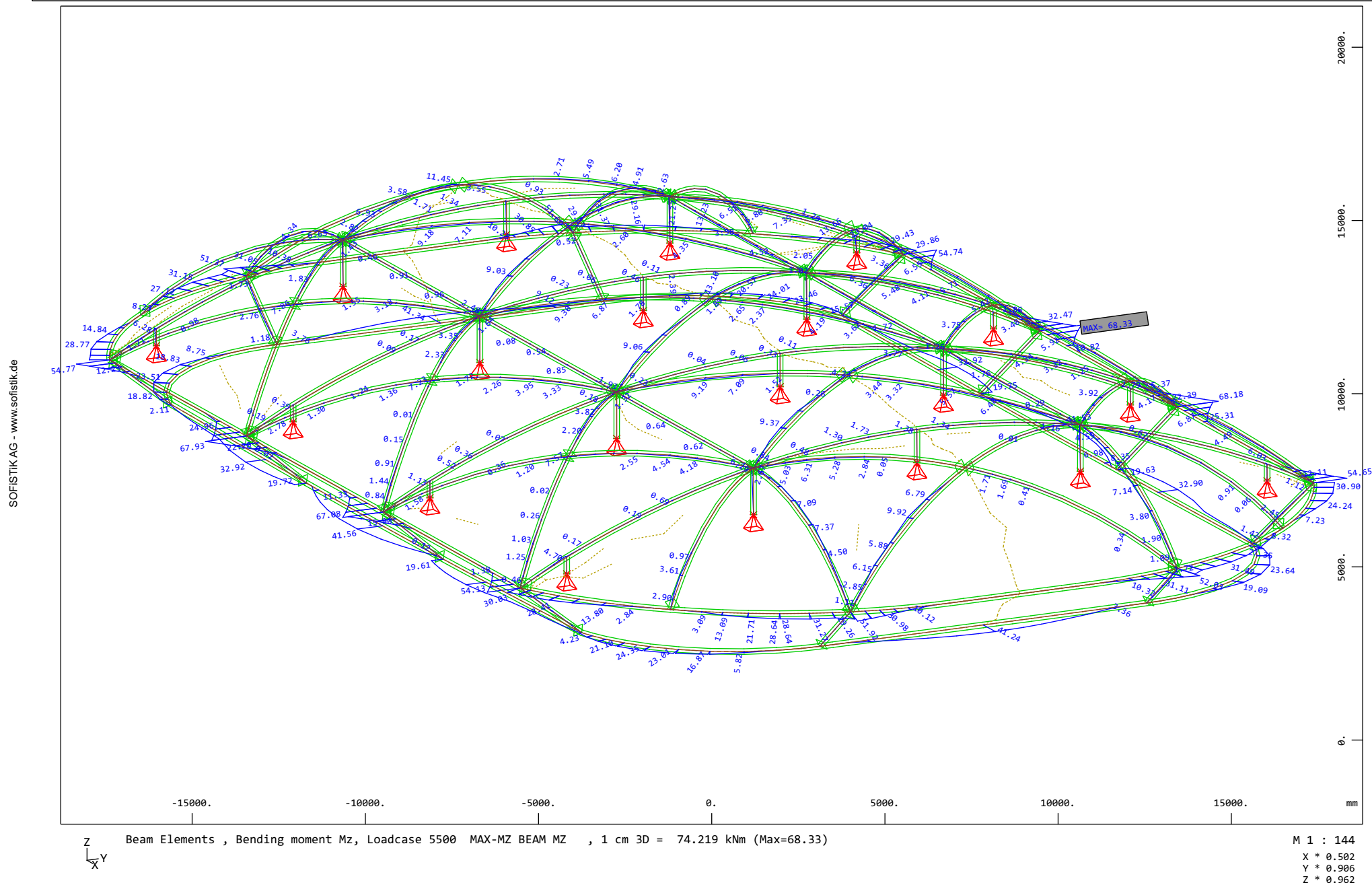

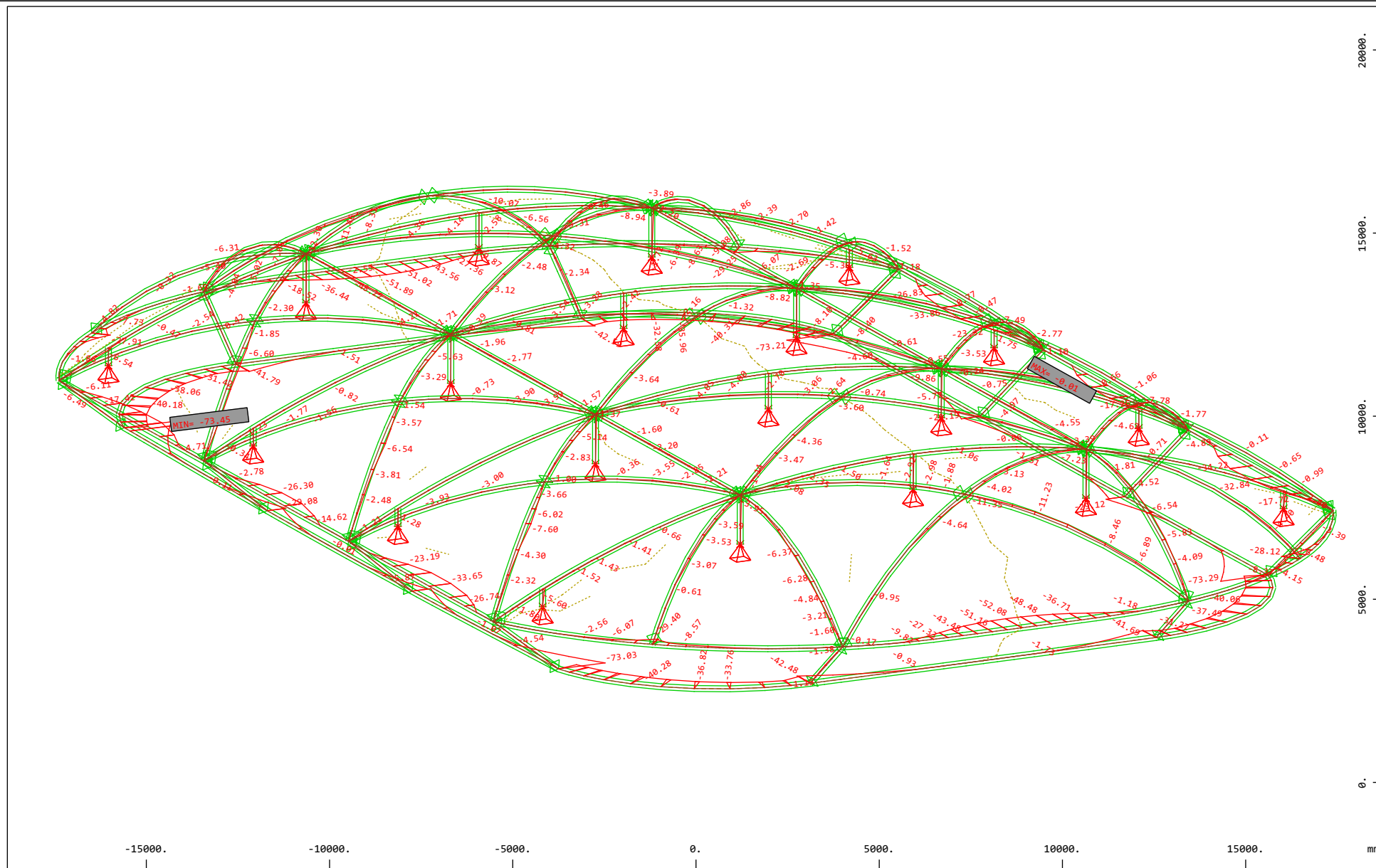

Z  
Y  
X

Beam Elements , Bending moment Mz, Loadcase 5501 MIN-MZ BEAM MZ , 1 cm 3D = 74.219 kNm (Min=-73.45) (Max=0)

M 1 : 144

X \* 0.502  
 Y \* 0.906  
 Z \* 0.962

SOFISTIK AG - www.sofistik.de

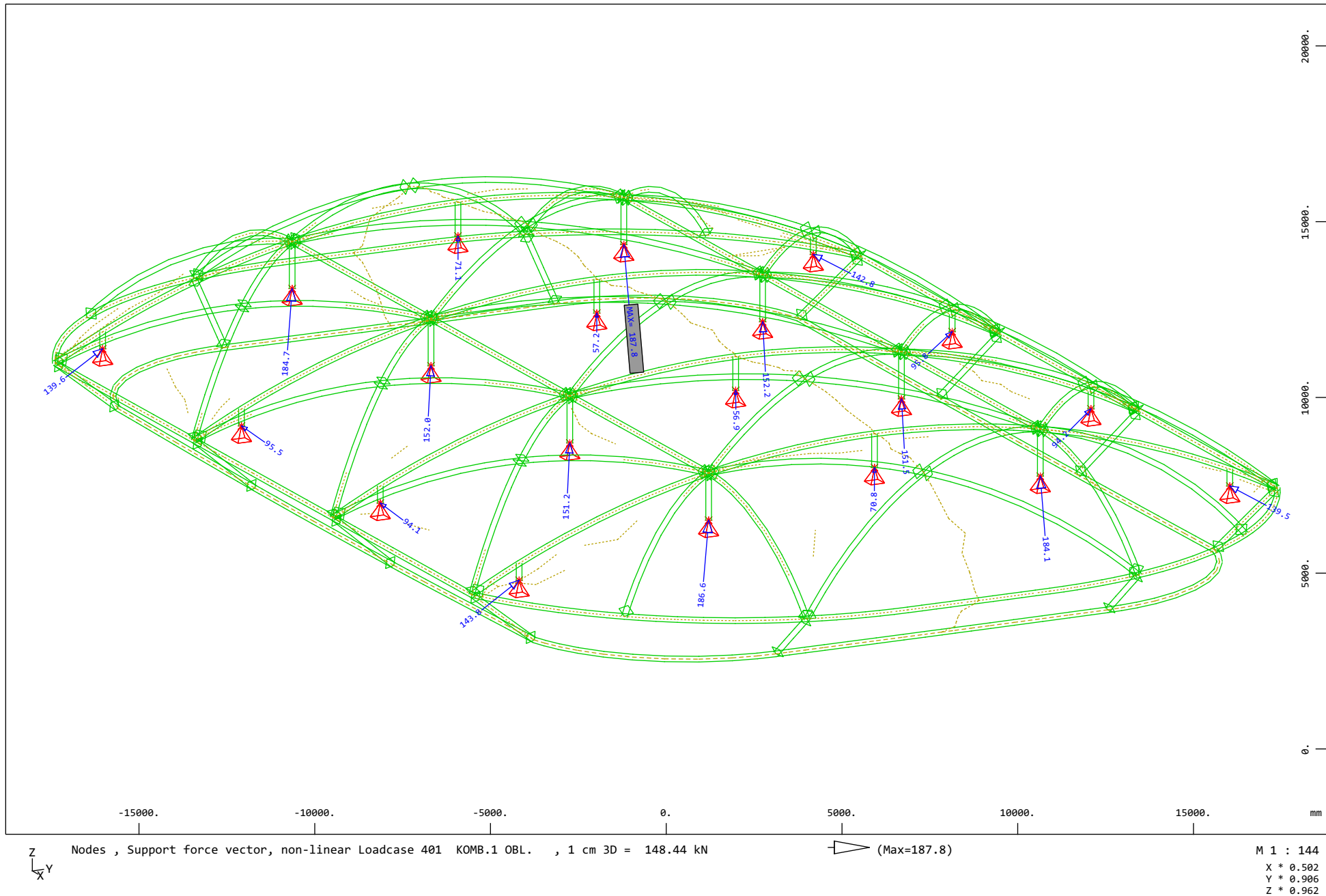



SOFISTIK AG - www.sofistik.de

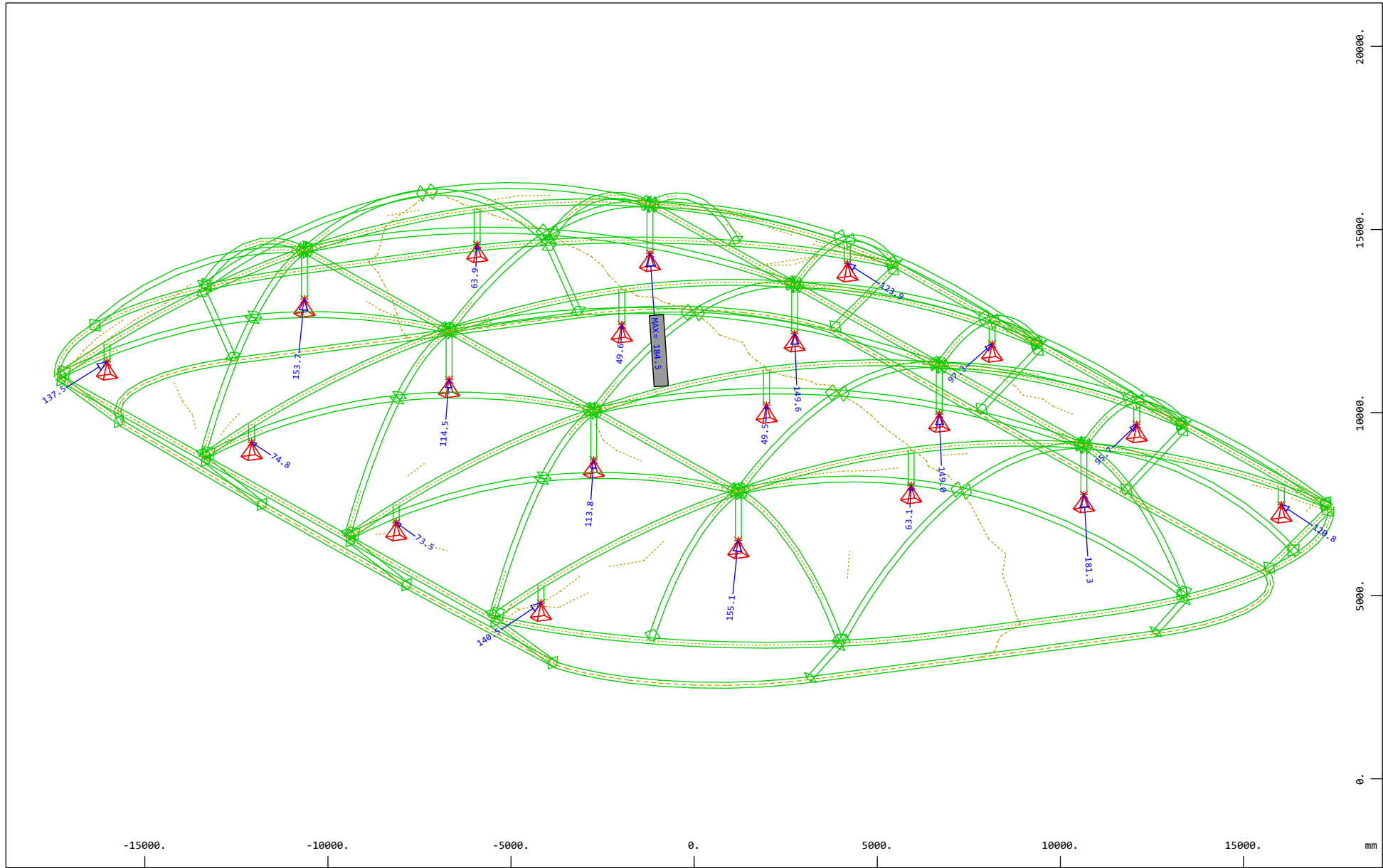

SOFiStiK AG - www.sofistik.de

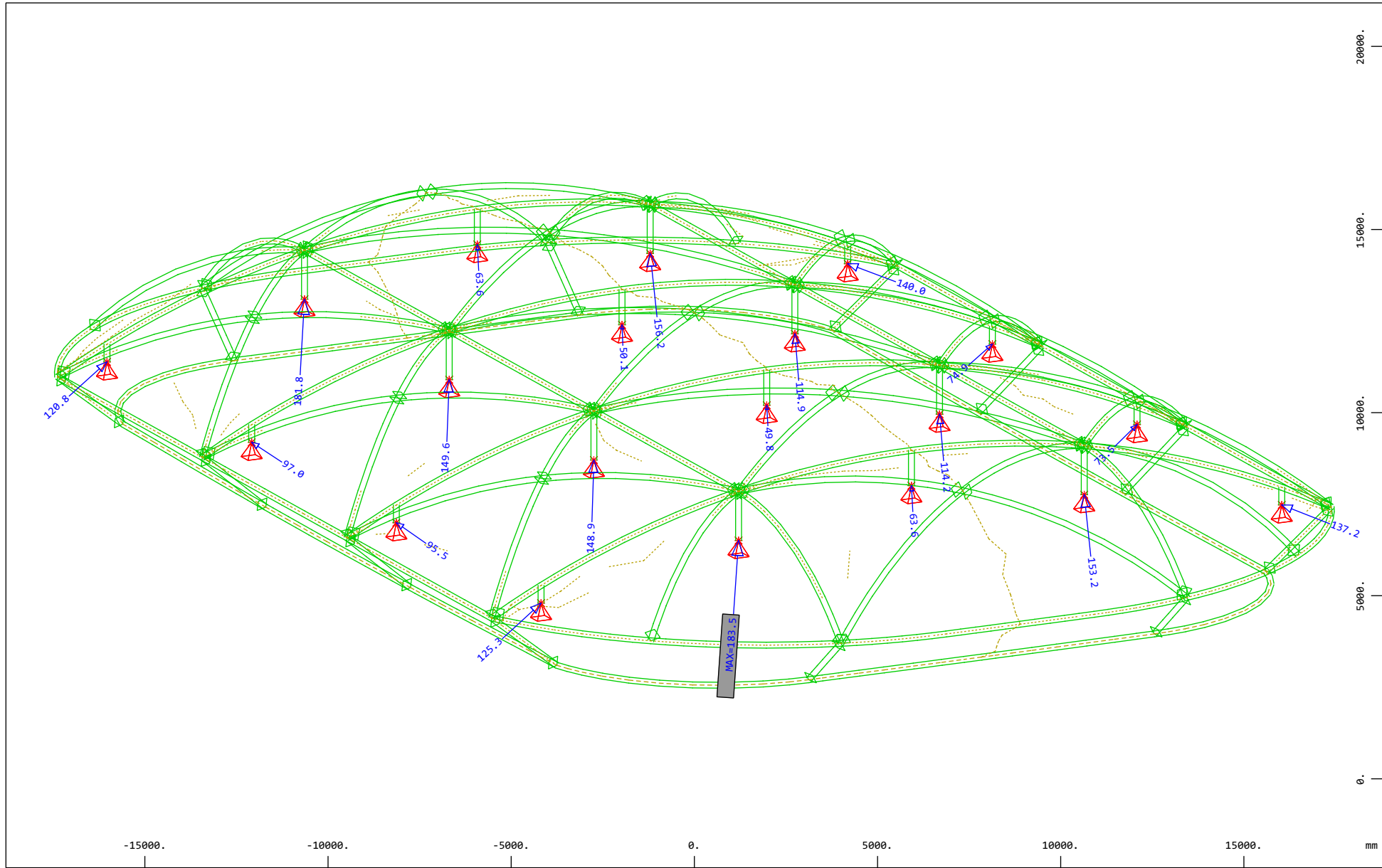

Z  
X Y

Nodes , Support force vector, non-linear Loadcase 403 KOMB.3 OBL. , 1 cm 3D = 123.44 kN

△ (Max=183.5)

M 1 : 144  
X \* 0.502  
Y \* 0.906  
Z \* 0.962

SOFISTIK AG - www.sofistik.de

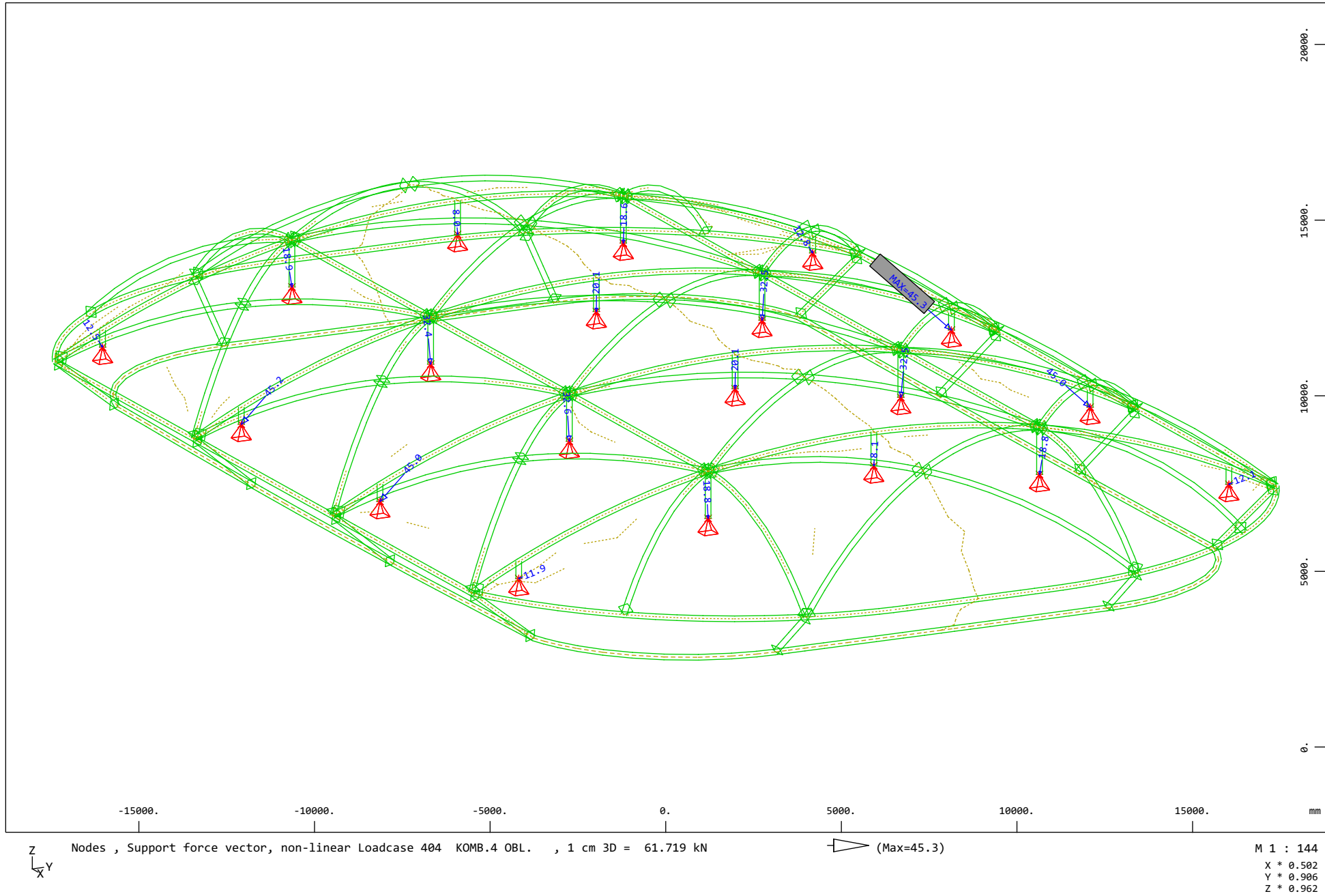

SOFISTIK AG - www.sofistik.de

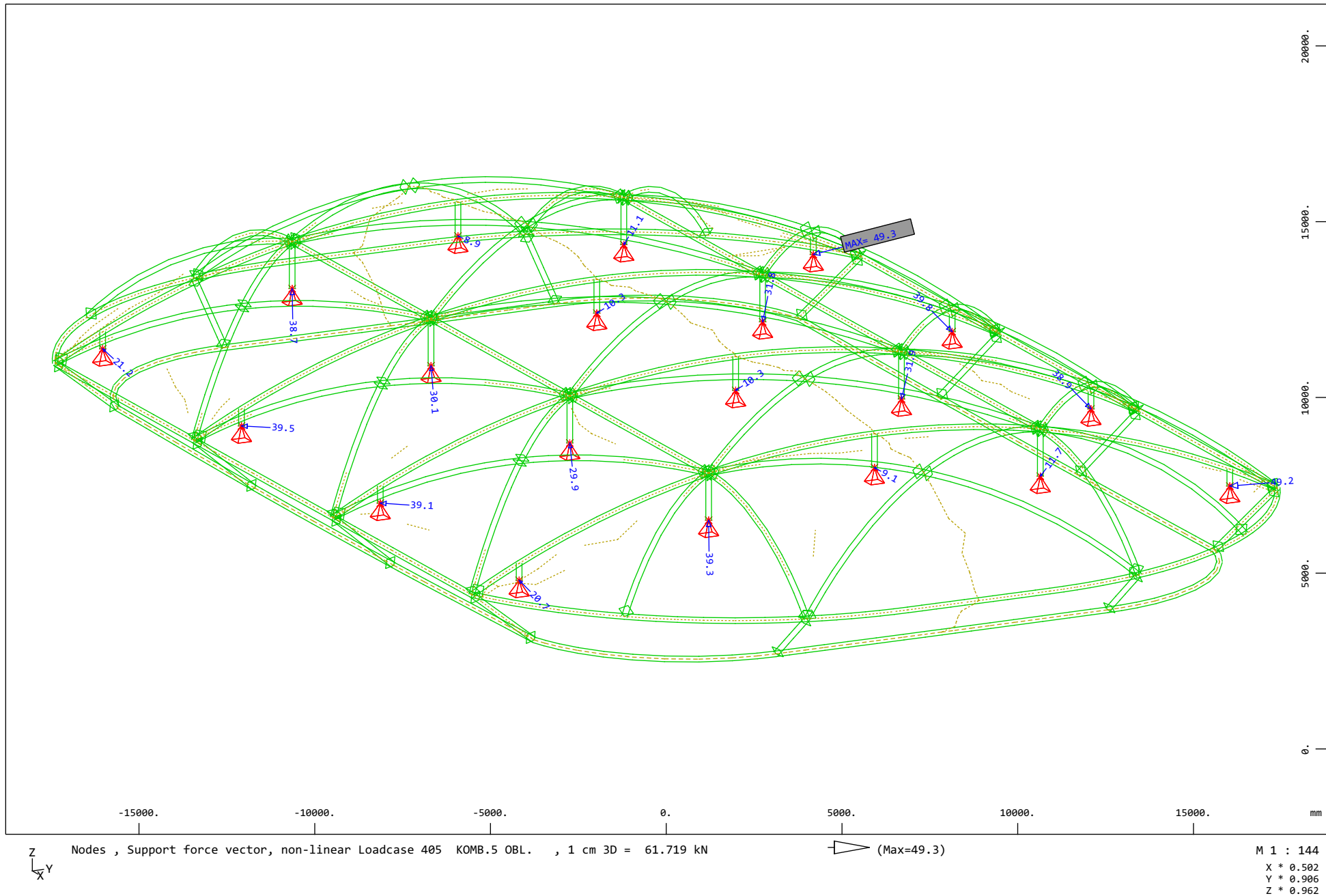



SOFISTIK AG - www.sofistik.de

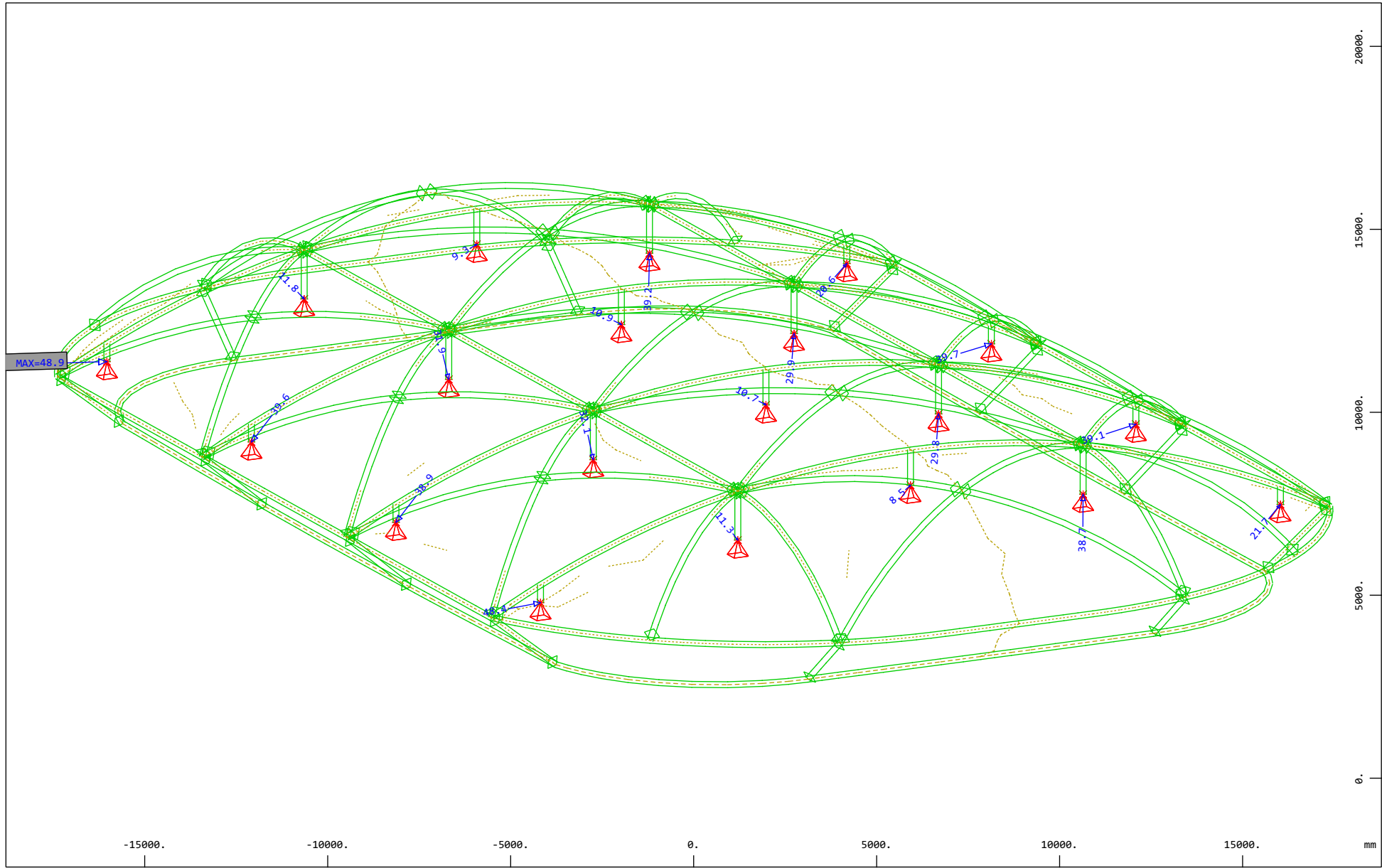

M 1 : 144  
X \* 0.502  
Y \* 0.906  
Z \* 0.962